

## ST-38 / ST-37

polarising filter, linear / circular

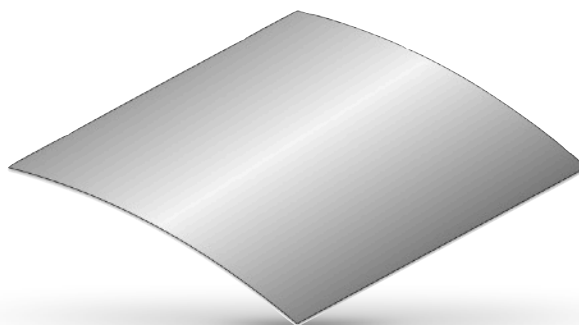

**SCREEN-TECH**  
VISUAL COMPONENTS



### Technical specifications

<b>Polarization axis</b>	0°/90° parallel to the edge, or 45°/135°, ST-37 0°/0° realD compatible
<b>Strength</b>	ST-38 in 0.2 mm and 0.7 mm, ST-37 in 0.4 mm, glass in 4 mm
<b>Formats</b> all cuts possible	ST-38-20 from roll 630 mm width in 0,2 mm thickness, 0°/90°, ST-38-20S sheets 710 x 406 x 0,2 mm self-adhesive, 0°/90°, ST-38-70 sheets 200 x 200 x 0,7 mm, 0°/90° ST-38-20V sheets up to 400 x 400 mm, 45°/135°, ST-37 sheets in 5 cm steps up to 30 x 30 cm, or 4 mm glass, 0°/0°
<b>Transmission</b>	42% ± 2%
<b>Parallel Transmission</b>	36% ± 2%
<b>Transmission crossed</b>	< 0,01%
<b>Degree of polarization</b>	99,98 %
<b>UV absorption</b>	< 1,0 at 380nm
<b>Spectral range</b>	380 - 780 nm
<b>Cutting</b>	laser, cutter knife, scissors, punch
<b>Temperature stability</b>	-40° up to +80°C / 500h
<b>Material</b>	PET, TAC, PVAL film, protective film on both sides - remove before use!
<b>Surface hardness</b>	2H
<b>Shrinkage</b>	< 2%